



Yuasa Ficha Técnica

Yuasa 6N6-3B - Convencional 6 Volt Batería

Rendimiento

| | |
|----------------------|-------|
| Tensión | 6V |
| Capacidad (10-hour) | 6Ah |
| Capacidad (20 horas) | 6.3Ah |

Dimensiones (± 2 mm)

| | |
|-------|-------|
| Largo | 99mm |
| Ancho | 57mm |
| Alto | 111mm |

Peso

| | |
|------------------|-------|
| Peso con Acido | 1.3kg |
| Volumen de acido | 0.3l |

Tecnología

| | |
|-------------|-------------|
| Tecnología | Placa Sb/Sb |
| Separadores | Leaf |

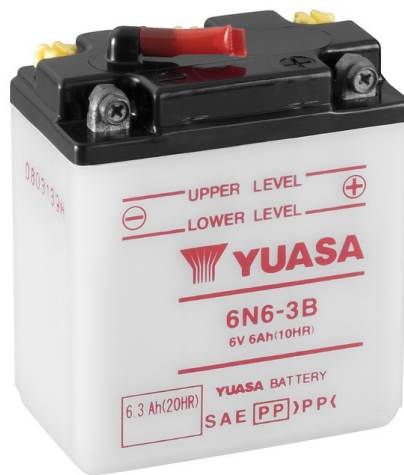

Esquema

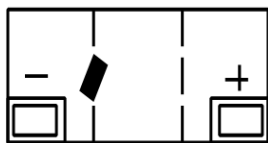

Tipo de terminal - 6

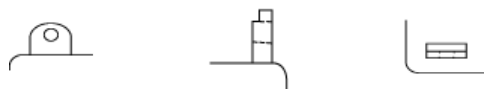

Fecha de emisión: 07/03/2020 - E&EO



Yuasa Technical Data Sheet

Yuasa 6N6-3B - Conventional 6 Volt Battery

Performance

| | |
|--------------------|-------|
| Voltage | 6V |
| Capacity (10-hour) | 6Ah |
| Capacity (20-hour) | 6.3Ah |

Dimensions (±2mm)

| | |
|--------|-------|
| Length | 99mm |
| Width | 57mm |
| Height | 111mm |

Weights & Measures

| | |
|-----------------------|-------|
| Mean Weight with Acid | 1.3kg |
| Acid Volume | 0.3l |

Technology

| | |
|------------|------------|
| Technology | Cast Sb/Sb |
| Separator | Leaf |



Cell Assembly Layout

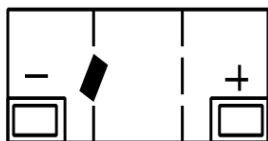

Terminal Type - 6

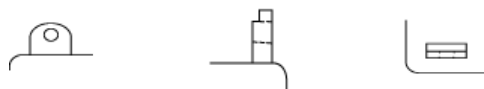

Data Sheet generated on 07/03/2020 - E&OE